

# Briv<sup>®</sup> High Shear, High Clamp Fasteners

Speed fasteners with a bulbed tail provide consistent high clamp and shear. Can be used to assemble many materials including metal, plastic and aluminium alloy.



## Key features and benefits

- Bulbed tail and foreshortening of the fastener during installation ensures high clamp
- Bulbed tail and large head style provide a large bearing area for soft materials
- Tapered tail for ease of hole entry
- Expands radially during installation to ensure maximum hole fill
- Lower in-place costs than welding or nail rivets
- Bright tin plated brass option for ease of soldering and good electrical conductivity
- Stainless steel option for applications subject to high temperature or corrosion
- Can be bowl fed for larger volume applications using automated equipment

## Specifications

Sizes:

2.4 mm (3/32") to 6 mm

Materials:

Aluminium Alloy, Steel,  
Stainless Steel A2, Brass

Head Styles:

Dome, Countersunk

## Typical placing sequence

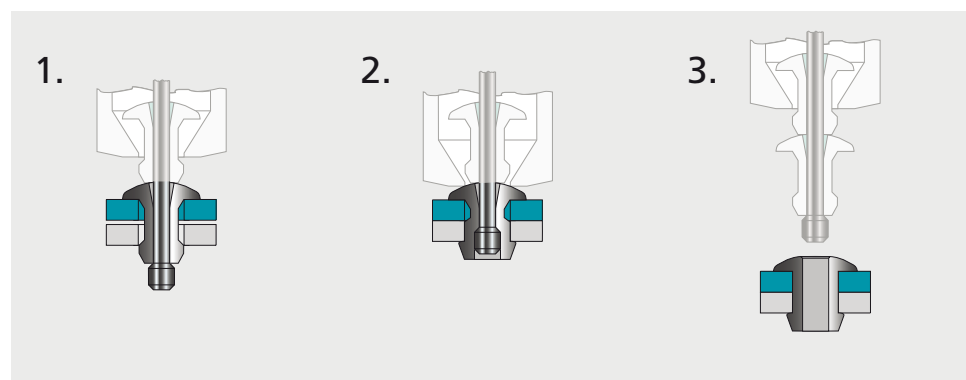

Please visit our website [www.StanleyEngineeredFastening.com](http://www.StanleyEngineeredFastening.com) for fastener placing animations.

## Assembly applications

- Automotive
- Electronic components
- Sheet metal
- Electrical engineering
- Domestic appliances
- Furniture
- General light fabrication

Vacuum pump for diesel engines



Domestic heating systems



Office furniture



Computer cabinet



Automotive plastic connector to moulded chassis

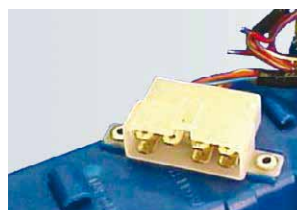

Automotive stereo speaker

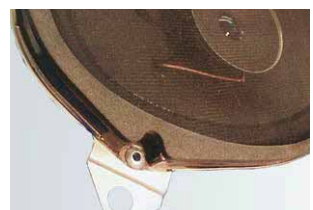

# Installation Systems

---

From cost-effective power tools to custom assembly systems, Speed Fastening® equipment offers rapid and reliable assembly to meet your specific requirements. The equipment is an integral part of the Speed Fastening System and offers the following benefits:

- High speed, reliable fastener feed
- Assembly cycle times within two seconds
- Single side assembly
- Simple operation
- Quick reload
- Low maintenance costs
- Ideal for low volume batch work through to fully automated assembly lines

## Power Tools

---

For low volume production up to 500,000 fastener p.a.

Power tools



753 Standard tool



7537 Power tool



## Workstations

---

For medium volume production from 250,000 up to 1,000,000 fastener p.a.

Workstations



7535 Pantograph workstation



Mini-MAS



## Assembly Workstations

---

For high volume production > 1,000,000 fastener p.a.

Bespoke systems



Twin head fixed pitch workstation

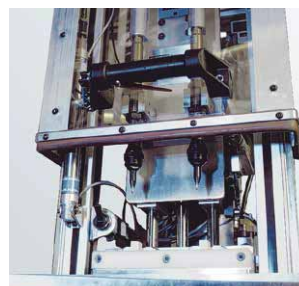

23 placing heads to assemble a computer chassis





English	Français	Deutsch	Italiano	Español
120° Countersunk	120° Tête fraisée	120° Senkkopf	120° Testa svasata	120° Cabeza avellanada
Aluminium alloy* (5 % Mg)	Alliage d'aluminium* (5% Mg)	Aluminium* (5 % Mg)	Lega di alluminio* (5% Mg)	Aluminio* (5% Mg)
Natural	Brut	Blank	Nessuna finitura	Natural

\*: BS 1473 5056A DIN 1725 AlMg5 Werkstoff 3.3555

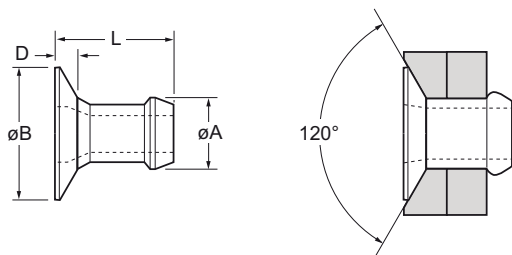

ø					øB	D	L	øA			Fasteners per pod Nombre de rivets par chargeur / Niete pro Magazin / Rivetti per caricatore / Uds./carga	Part No/ref
nom.	min.	max.	min.	max.	max.	max.	max.	max.	kN <sup>1)</sup>	kN <sup>1)</sup>	± 1	
3.2 (1/8")	1.52	2.79	3.26	3.34	5.84	0.76	4.77	3.17	0.76	1.31	64	01802-00406
	2.54	3.81					5.79				52	01802-00407
	3.56	4.83					6.81				44	01802-00408
	4.57	5.84					7.82				38	01802-00410
	5.59	6.86					8.84				33	01802-00411
4.0 (5/32")	1.57	2.93	3.97	4.04	6.98	1.02	5.18	3.90	1.13	1.73	59	01802-00505
	2.15	3.43					5.69				54	01802-00506
	2.66	3.94					6.19				49	01802-00507
	3.68	4.96					7.21				42	01802-00509
	4.69	5.97					8.22				36	01802-00511
	5.71	6.99					9.24				32	01802-00513

all dimensions in mm / en millimètres / alle Maße in mm / in millimetri / en milímetros

1) typical values / valeurs moyennes / typische Werte / Valori tipici / valores típicos