

## ProGrip Rivet Nuts

### 0142 Steel Large Flange Splined Euro Range

Issue #1-2017

The most cost effective method of installing a full depth thread in thin gauge materials, ProGrip Rivet Nuts come in a variety of forms. Ideal for use in drilled or punched holes, ProGrip Rivet Nuts are installed from one side making them especially suitable for tube, box sections or tight corners. A comprehensive range of inserts is available in a large range of metric thread sizes to suit most applications.

Large flange inserts offer increased push out and torque to turn values. The flange provides an increased load bearing area and reinforces the hole in thinner gauge applications.



#### 0142 Series Large Flange Splined Steel Euro Range

Thread Size	Part Number	Grip Range	Hole Size -0.0 +0.1	D MAX	L	H	P
M3 X 0.5	0142-0320	0.5-2.0	5.0	4.9	10.5	8.0	0.75
M4 X 0.7	0142-0425	0.5-2.5	6.0	5.96	11.2	9.0	0.8
M5 X 0.8	0142-0525	0.5-2.5	7.0	6.96	13.2	10.0	1.0
M6 X 1.0	0142-0630	0.5-3.0	9.0	8.9	16.0	13.0	1.5
M8 X 1.25	0142-0830	0.5-3.0	11.0	10.9	17.5	16.0	1.5
M10 X 1.5	0142-1040	0.5-4.0	13.0	12.96	24.0	19.0	2.0
M12 X 1.75	0142-1240	1.0-4.0	16.1	16.0	25.0	23.0	2.0

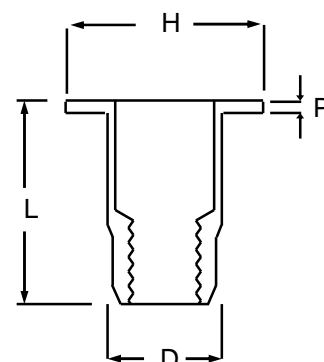

Steel inserts are supplied zinc plated and passivated.

All plating materials are RoHS/WEEE compliant.

All dimensions in millimetres

#### ZygoLOGY Rivet Nut Tools

ZygoLOGY offers a comprehensive range of air, battery and hand operated tools available to choose from on the placing tools page of our website. These can be found by [clicking here](#) or by going to:

[www.zygology.com/productcart/pc/Tools-for-rivet-nuts.html](http://www.zygology.com/productcart/pc/Tools-for-rivet-nuts.html)

If you need assistance deciding which is the right tool for you please call us free on 0808 123 1221 and we will be happy to advise you of the best tool for your requirements

