

ProGrip Rivet Nuts

Issue #1-2017

0114 - Steel Full Hex Low Profile Range, Metric A/F Hole

The most cost effective method of installing a full depth thread in thin gauge materials, ProGrip Rivet Nuts come in a variety of forms. Ideal for use in drilled or punched holes, ProGrip Rivet Nuts are installed from one side making them especially suitable for tube, box sections or tight corners. A comprehensive range of inserts is available in a large range of metric thread sizes to suit most applications.

The standard low profile insert gives a near flush finish in sheet materials without the need to countersink the hole. Hex inserts provide very high torque to turn values and are especially useful in applications where there is a risk of corrosion or contamination causing the bolt thread to seize during removal.

Hex inserts require a pre-punched hexagonal hole



0114 Series Steel Hex Low Profile Range Full Hex body for Metric A/F hole

Thread Size	Part Number	Grip Range	Hole Size A/F -0.0 +0.1	D	L	H A/F	P
M4 X 0.7	0114-0425	0.5-2.5	6.0	5.9	10.0	6.9	0.5
M5 X 0.8	0114-0530	0.5-3.0	7.0	6.9	12.0	7.8	0.5
M6 X 1.0	0114-0633	0.5-3.3	9.0	8.9	15.0	10.0	0.5
M8 X 1.25	0114-0833	0.5-3.3	11.0	11.0	17.5	12.0	0.6
M10 X 1.5	0114-1035	0.7-3.5	13.0	13.1	23.0	14.6	0.8

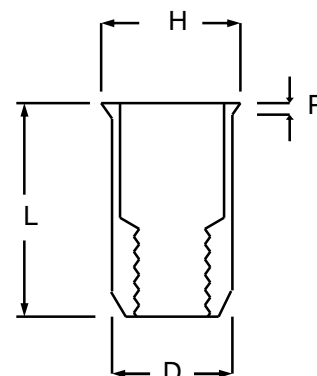

Steel inserts are supplied zinc plated and passivated.

All plating materials are RoHS/WEEE compliant.

All dimensions in millimetres

ZygoLOGY Rivet Nut Tools

ZygoLOGY offers a comprehensive range of air, battery and hand operated tools available to choose from on the placing tools page of our website. These can be found by [clicking here](#) or by going to:

www.zygology.com/productcart/pc/Tools-for-rivet-nuts.html

If you need assistance deciding which is the right tool for you please call us free on 0808 123 1221 and we will be happy to advise you of the best tool for your requirements

