

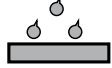

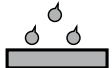



English	Français	Deutsch	Italiano	Español	***
Body: Carbon steel* Zinc plated Clear trivalent passivated	Corps: Acier* Revêtement zingué Passivation claire trivalente	Hülse: Stahl* Verzinkt Klar chromatiert, Cr6-frei	Corpo: Acciaio* Zincata Passivazione chiara trivalente	Cuerpo: Acero al carbono* Zincado, Pasivado claro trivalente	 240 h
Stem: Carbon steel** Black oxide	Tige: Acier** Noir	Dorn: Stahl** Schwarz brüniert	Gambo: Acciaio** Passivato nero	Vástago: Acero al carbono** Pavonado	 8 h

*: SAE 1008 EN 10263-2 C8C **: SCM 435 SAE 4135 EN 10263-4 34CrMo4

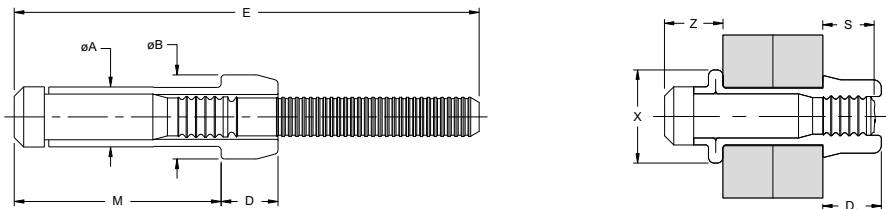
***: to red rust / à la rouille rouge / bis Rotrost / alla ruggine rossa / al óxido rojo (ASTM B117)

Note / Note / Hinweis / Nota / Nota: Bodies are supplied lubricated and must not be degreased. / Les corps sont lubrifiés et ne doivent pas être dégraissés. / Hülsen sind mit einem Gleitmittel beschichtet, welches nicht entfernt werden darf. / I corpi sono forniti lubrificati e non devono essere sgrassati. / Los cuerpos se suministran lubricados y no deben ser desengrasados.



Ø nom.					ØA max.	ØB max.	D max.	D ₁ max.	E min.	M max.	S max.	X nom.	Z max.	 kN min.	 kN min.	Part No/ref
	min.	max.	min.	max.												
4.8 (3/16")	2.36	3.99	5.28	5.64	5.26	7.32	4.95	5.26	37.11	12.41	6.38	7.54	5.35	12.40	8.00	21021-00602
	3.99	5.59							38.69	14.01						21021-00603
	5.59	7.16							40.27	15.59						21021-00604
	7.16	8.76							41.84	17.19						21021-00605
	8.76	10.34							43.41	18.76						21021-00606
	10.34	11.94							44.99	20.36						21021-00607
	11.94	13.51							46.56	21.94						21021-00608
	13.51	15.11							48.14	23.54						21021-00609
	15.11	16.69							49.71	25.11						21021-00610
	16.69	18.29							51.29	26.71						21021-00611
	18.29	19.89							52.86	28.29						21021-00612
	6.4 (1/4")	2.36							3.99	7.04						7.42
3.99		5.59	47.32	18.11	21021-00803											
5.59		7.16	48.89	19.69	21021-00804											
7.16		8.76	50.47	21.29	21021-00805											
8.76		10.34	52.04	22.86	21021-00806											
10.34		11.94	53.62	24.46	21021-00807											
11.94		13.51	55.19	26.04	21021-00808											
13.51		15.11	56.77	27.64	21021-00809											
15.11		16.69	58.34	29.21	21021-00810											
16.69		18.29	59.92	30.81	21021-00811											
18.29		19.89	61.49	32.39	21021-00812											
8.0 (5/16")		4.78	7.95	8.84	9.35	8.76	12.39	8.61	9.20		62.42	23.31	10.25	12.28	9.10	
	7.95	11.13	65.57							26.49	21021-01006					
	11.13	14.30	68.72							29.66	21021-01008					
	14.30	17.48	71.87							32.84	21021-01010					
	17.48	20.65	75.02							36.01	21021-01012					
	20.65	23.83	78.17							39.19	21021-01014					
	23.83	26.97	81.32							42.36	21021-01016					

all dimensions in mm / en millimètres / alle Maße in mm / in millimetri / en milímetros