

## Value Rivet Nuts 0182 - Countersunk Steel Euro Range

Issue #1-2008

The most cost effective method of installing a full depth thread in thin gauge materials, Value Rivet Nuts come in a variety of forms. Ideal for use in drilled or punched holes, Value Rivet Nuts are installed from one side making them especially suitable for tube, box sections or tight corners. A comprehensive range of inserts is available in a large range of metric thread sizes to suit most applications.

Countersunk Inserts give a totally flush finish when installed. In addition the countersunk feature allows the insert to work in slightly thicker material than standard low profile inserts. The hole must be countersunk prior to installation of the insert, and it is important that the minimum sheet thickness is observed.

							
<b>0182 Series Countersunk Steel Euro Range</b>							
Thread Size	Part Number	Grip Range	Hole Size -0.0 +0.1	D	L	H	P
M3 X 0.5	0182-0320	0.5-2.0	5.0	4.95	9.0	7.0	1.5
M4 X 0.7	0182-0440	1.0-4.0	6.0	5.95	11.5	8.5	1.5
M5 X 0.8	0182-0545	1.5-4.5	7.0	6.95	13.0	9.5	1.5
M6 X 1.0	0182-0645	1.5-4.5	9.0	8.95	16.0	11.3	1.5
M8 X 1.25	0182-0845	1.5-4.5	11.0	10.95	18.5	13.6	1.5

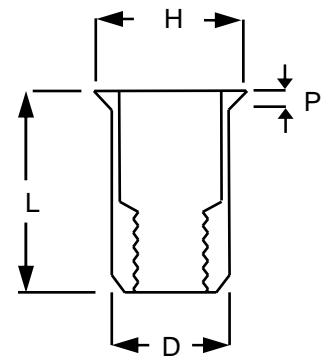

Steel inserts are supplied zinc plated and passivated. All plating materials are RoHS/WEEE compliant.

All dimensions in millimetres

### 7420 Rivet Nut Placing Tool

A fast ergonomically designed tool, designed to place threaded inserts quickly and uniformly. Using a hydro pneumatic spin-pull system the 742 has an automatic action to spin the insert onto the mandrel. Once the insert is engaged, a single pull of the trigger places the insert and reverses the tool off. The total cycle time is no more than a couple of seconds.

Nose equipment is quick and simple to change and mandrels (the only consumable item) are cheap and easy to come by in an emergency. Capable of placing inserts from M3 to M12, the 742 is easily adjusted for different applications without recourse to special tools.

